

pottery barn kids

thomas wall system media base & hutch

PRE-ASSEMBLY:

- Please read all instructions carefully before assembling.
- For your safety, assembly by two people is recommended.
- Save all packing materials until assembly is complete to avoid accidentally discarding smaller parts or hardware.
- The use of power tools during the assembly of this item can cause the hardware to strip or the wood to split. Please proceed with extreme care.
- **The wall system should not be moved unless the connector screws are removed.**

PARTS REQUIRED :

- (A) Media Hutch – 1pc
- (B) Media Base Left – 1pc

HARDWARE ENCLOSED :

- (C) PHS M4 x 16mm – 8pcs
- (D) T Mending Plate – 2pcs

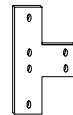

TOOLS REQUIRED:

- Philips head screwdriver (not included)

ASSEMBLY:

1. Using 2 people, carefully raise the Media Hutch (A) and set it onto the Media Base (B) as shown. Attach the T mending plate (D) by aligning with the pre-drilled pilot holes. Use PHS screws (C) to fasten the connection by applying gentle pressure to bore through the pilot holes and into the cases. Do not over tighten. Repeat the same procedure for the other side. (Fig.1)
2. Assembly is complete. (Fig. 2)

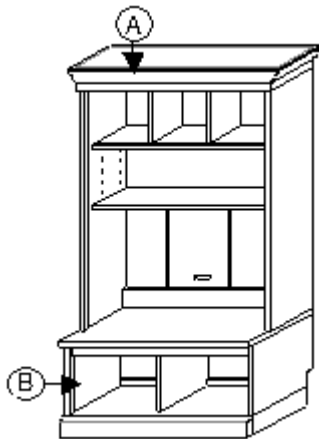

(Fig. 1)

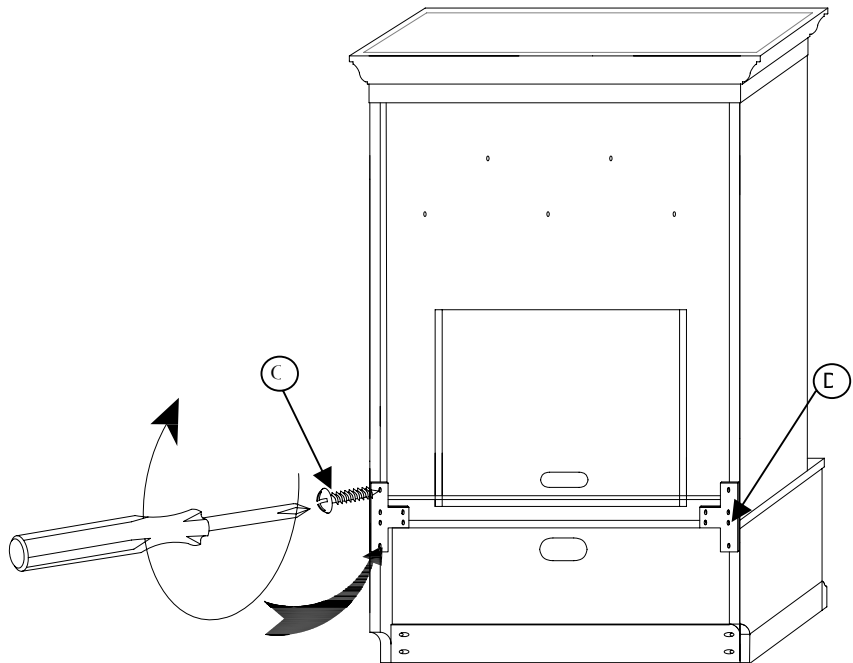

(Fig. 2)

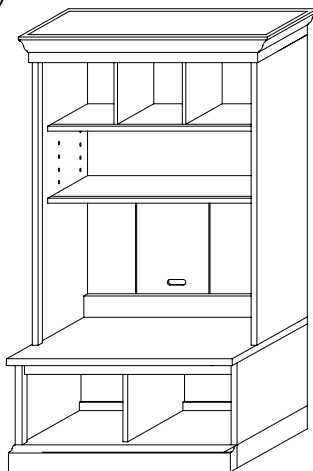

CARE INSTRUCTIONS:

- Dust with a clean, soft cloth
- Avoid the use of chemicals and harsh cleaning agents

Thank you for your purchase
stores | catalog | www.potterybarnkids.com
USA 1.800.290.8181